

glassprofile



 **profilpas**[®]
you build we profile

glassprofile

Glass Profile è una linea di profili in acciaio inox per la realizzazione di piatti doccia filo pavimento. Coprendo elegantemente il dislivello del piano inclinato con pendenza al 2%, Glass Profile crea una superficie complanare dal design moderno e lineare. L'utilizzo di acciaio inox garantisce inoltre un'ottima durata nel tempo, assicurando un prodotto di elevato contenuto estetico e funzionale.

Glass Profile is a line of stainless steel profiles for the creation of floor-level shower surfaces. Glass Profile creates a coplanar surface characterized by a modern and linear design, by covering the difference in height of the surface with 2% slope. The use of stainless steel guarantees an excellent duration over time and a high aesthetic and functional value of the product.







GPS1/



GPS1/DX/19 acciaio inox satinato AISI 304 DIN 1.4301
GPS1/DX/19 satin stainless steel AISI 304 DIN 1.4301

Glass Profile GPS1/ è un profilo in acciaio inox per l'inserimento di pareti di separazione in vetro di docce a filo pavimento. GPS1/ è provvisto sul lato interno della doccia di pendenza al 2% per una soluzione estetica perfetta di tutto il piano inclinato. GPS/6 è il terminale a completamento del profilo per nascondere la sezione in vista della parete in vetro.

Glass Profile GPS1/ is a stainless steel profile for the insertion of glass walls of floor-level showers.

GPS1/ is provided with a 2% slope on the shower inner side for a perfect aesthetic solution of the sloped surface.

On completion of the profile, there is GPS/6, the end cap for hiding the section of the glass wall.

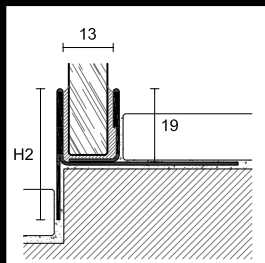

GPS1/DX/19

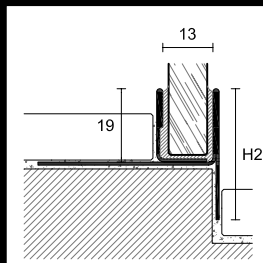

GPS1/SX/19

Per i mercati di Germania, Austria e Svizzera è disponibile la versione componibile in due pezzi GPS7/.

For the markets of Germany, Austria and Switzerland, the double pieces version GPS7/ is available.

GPS2/ GPS14/



GPS2/19 acciaio inox satinato AISI 304 DIN 1.4301
GPS2/19 satin stainless steel AISI 304 DIN 1.4301



GPS14/12 acciaio inox satinato AISI 304 DIN 1.4301
GPS14/12 satin stainless steel AISI 304 DIN 1.4301

Glass Profile GPS2/ è un profilo in acciaio inox per l'inserimento di pareti di separazione in vetro a rivestimento di docce a filo pavimento. Di semplice montaggio, è adatto a piastrelle di qualsiasi spessore e non necessita di forature. GPS/6 è il terminale a completamento del profilo per nascondere la sezione in vista della parete in vetro.

Glass Profile GPS2/ is a stainless steel profile for the insertion of glass walls of floor-level showers on the wall covering. It is easy to install, is suitable for tiles of any thickness and does not need drillings. On completion of the profile, there is GPS/6, the end cap for hiding the section of the glass wall.

Glass Profile GPS14/ è un profilo in acciaio inox adatto all'inserimento di pareti in vetro. Il profilo va fissato direttamente sui rivestimenti già posati. Le guarnizioni siliconiche di varie misure completano la gamma Glass Profile e sono da utilizzare come fermavetro nei profili che ne prevedono l'inserimento.

Glass Profile GPS14/ is a stainless steel profile suitable for the insertion of glass walls on the wall covering. This profile can be directly installed on wall coverings already laid. The silicone seals of different sizes complete the Glass Profile range and can be used inside the profiles to keep the glass stable.

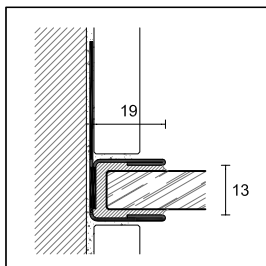

GPS2/19

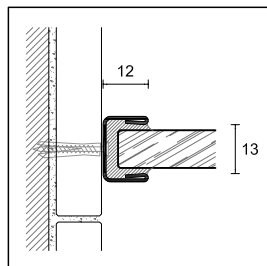

GPS14/12

GPS3/

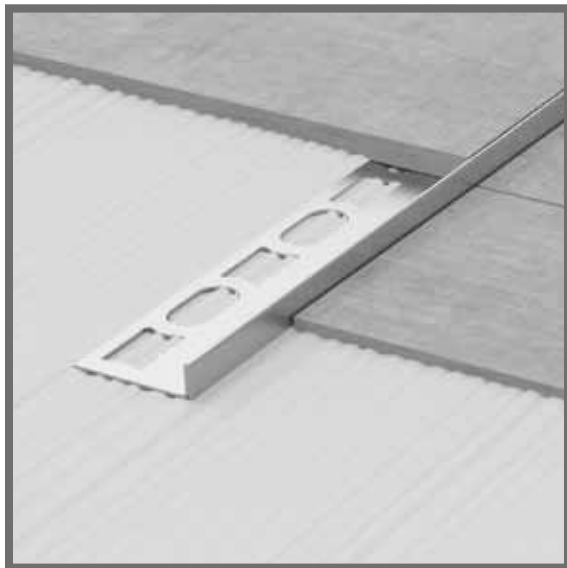

GPS3/SX/10 acciaio inox satinato AISI 304 DIN 1.4301
GPS3/SX/10 satin stainless steel AISI 304 DIN 1.4301

Glass Profile GPS3/ è un profilo in acciaio inox provvisto sul lato interno della doccia di pendenza al 2% per una soluzione estetica perfetta dei fianchi del piano inclinato.

Glass Profile GPS3/ is a stainless steel profile provided with a 2% slope on the shower inner side for a perfect aesthetic solution of the sides of the sloped surface.

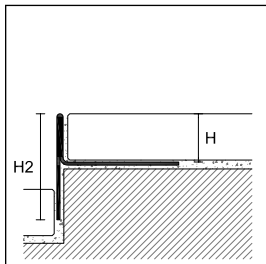

GPS3/DX/

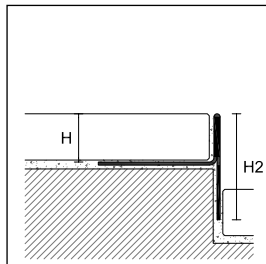

GPS3/SX/

Per i mercati di Germania, Austria e Svizzera è disponibile la versione componibile in due pezzi GPS8/.

For the markets of Germany, Austria and Switzerland, the double pieces version GPS8/ is available.



GPS4/

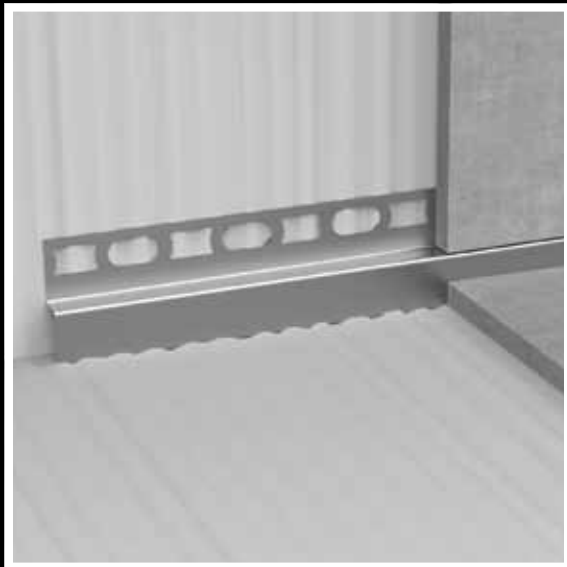

Glass Profile GPS4/ è un profilo in acciaio inox provvisto sul lato interno della doccia di pendenza al 2%. Risolve perfettamente il collegamento tra pavimento inclinato e rivestimento eliminando il taglio obliquo della piastrella.

Glass Profile GPS4/ is a stainless steel profile provided with a 2% slope on the shower inner side. It connects the sloped floor and the covering perfectly, thus avoiding the oblique cut of the tiles.

GPS4/SX/10 acciaio inox satinato AISI 304 DIN 1.4301
GPS4/SX/10 satin stainless steel AISI 304 DIN 1.4301

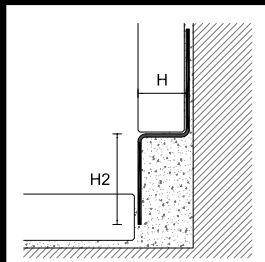

GPS4/DX/

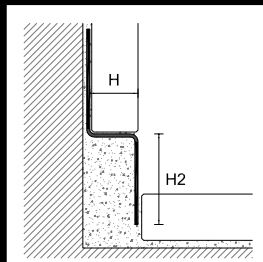

GPS4/SX/

GPS5/



Glass Profile GPS5/ è un profilo in acciaio inox da posizionare a rivestimento, sopra la canalina doccia con piano inclinato, per evitare di tagliare le piastrelle a misura.

Glass Profile GPS5/ is a stainless steel profile to be positioned on the wall covering, above the shower drain with sloped surface, in order to avoid the cut of the tiles.

GPS5/ acciaio inox satinato AISI 304 DIN 1.4301
GPS5/ satin stainless steel AISI 304 DIN 1.4301

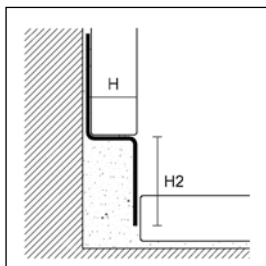

GPS5/

GU/ - TGU/



GU/ e TGU/ sono dei profili in alluminio anodizzato adatti ad essere utilizzati per l'inserimento di pareti di separazione in vetro per docce a filo pavimento.

GU/ and TGU/ are anodised aluminium profiles suitable for the insertion of glass walls of floor-level showers.

GU/40/12 alluminio anodizzato argento
GU/40/12 silver anodised aluminium

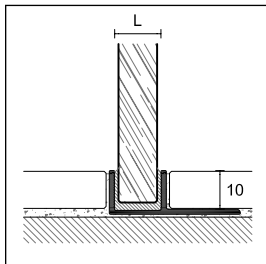

TGU/

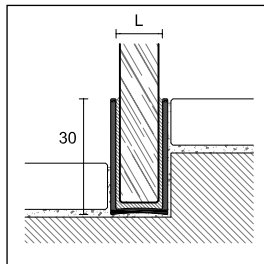

GU/30/

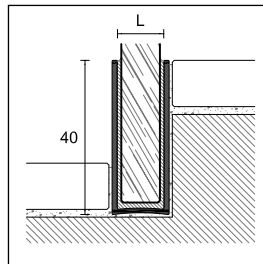

GU/40/



GPS1/

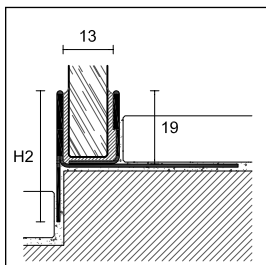

GPS1/DX/19

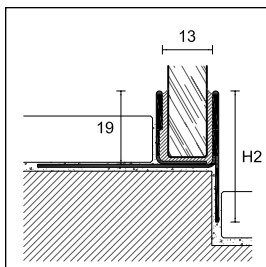

GPS1/SX/19

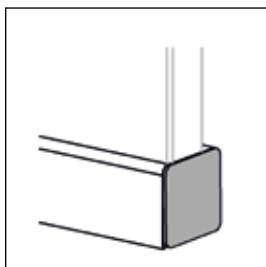

GPS/6

ART.

GPS1/ /19

ACCIAIO - STAINLESS STEEL

	DX	SX	DX	SX	DX	SX	DX	SX
lunghezza - length cm	98		120		148		200	
H2 mm	34		37		42		60	
acciaio inox satinato AISI 304 DIN 1.4301 satin stainless steel AISI 304 DIN 1.4301		31505 31507	31515 31517	31525 31527	31535 31537			



GPS1/DX/19



GPS1/SX/19

TERMINALE - END CAP

ART.

ACCIAIO - STAINLESS STEEL

GPS/6	acciaio inox satinato AISI 304 DIN 1.4301 satin stainless steel AISI 304 DIN 1.4301		31564
-------	--	---	-------

GPS2/

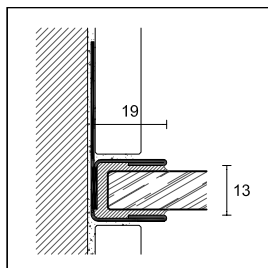

GPS2/19

ART. **GPS2/19**

ACCIAIO - STAINLESS STEEL

lung. cm - length cm	200	250
acciaio inox satinato AISI 304 DIN 1.4301 satin stainless steel AISI 304 DIN 1.4301	31543	31544

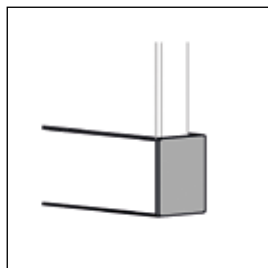

GPS/6

TERMINALE - END CAP

ART.

ACCIAIO - STAINLESS STEEL

GPS/6	acciaio inox satinato AISI 304 DIN 1.4301 satin stainless steel AISI 304 DIN 1.4301	31564
--------------	--	-------

GPS14/

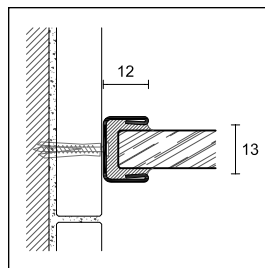

GPS14/12

ART. **GPS14/12**

ACCIAIO - STAINLESS STEEL

lung. cm - length cm	210	250
acciaio inox satinato AISI 304 DIN 1.4301 satin stainless steel AISI 304 DIN 1.4301	32000	32001



guarnizioni fermavetro in silicone trasparente
silicone seals

GUARNIZIONE FERMAVETRO IN SILICONE TRASPARENTE SILICONE SEALS

ART.	misura - measures	
GG/2	spessore 2 mm thickness 2 mm	31590
GG/3	spessore 3 mm thickness 3 mm	31592
GG/4	spessore 4 mm thickness 4 mm	31594

GPS3/

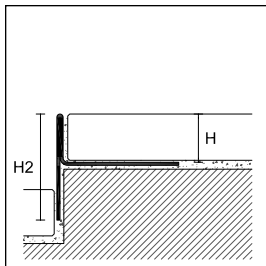

GPS3/DX/

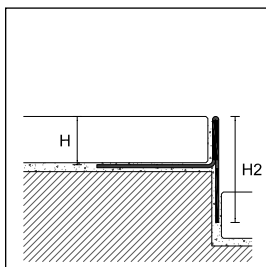

GPS3/SX/



GPS3/DX/



GPS3/SX/

lunghezza = 98 cm - length = 98 cm

ART.	finitura - finishing		H	H2	DX	SX
ACCIAIO - STAINLESS STEEL						
GPS3/10	acciaio inox satinato AISI 304 DIN 1.4301 satin stainless steel AISI 304 DIN 1.4301		10	25	31615	31617
GPS3/12	acciaio inox satinato AISI 304 DIN 1.4301 satin stainless steel AISI 304 DIN 1.4301		12,5	27,5	31625	31627

lunghezza = 120 cm - length = 120 cm

ART.	finitura - finishing		H	H2	DX	SX
ACCIAIO - STAINLESS STEEL						
GPS3/10	acciaio inox satinato AISI 304 DIN 1.4301 satin stainless steel AISI 304 DIN 1.4301		10	28	31645	31647
GPS3/12	acciaio inox satinato AISI 304 DIN 1.4301 satin stainless steel AISI 304 DIN 1.4301		12,5	30,5	31655	31657

lunghezza = 148 cm - length = 148 cm

ART.	finitura - finishing		H	H2	DX	SX
ACCIAIO - STAINLESS STEEL						
GPS3/10	acciaio inox satinato AISI 304 DIN 1.4301 satin stainless steel AISI 304 DIN 1.4301		10	33	31675	31677
GPS3/12	acciaio inox satinato AISI 304 DIN 1.4301 satin stainless steel AISI 304 DIN 1.4301		12,5	35,5	31685	31687

lunghezza = 200 cm - length = 200 cm

ART.	finitura - finishing		H	H2	DX	SX
ACCIAIO - STAINLESS STEEL						
GPS3/10	acciaio inox satinato AISI 304 DIN 1.4301 satin stainless steel AISI 304 DIN 1.4301		10	51	31694	31695
GPS3/12	acciaio inox satinato AISI 304 DIN 1.4301 satin stainless steel AISI 304 DIN 1.4301		12,5	53,5	31698	31699

GPS4/

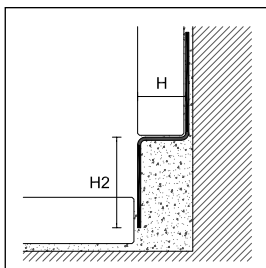

GPS4/DX/

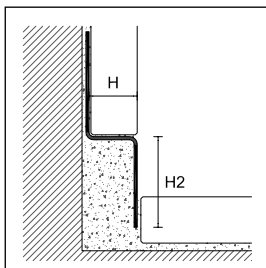

GPS4/SX/



GPS4/DX/

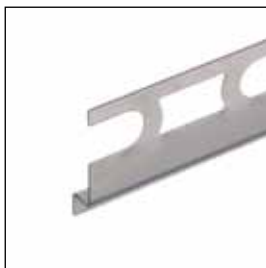

GPS4/SX/

lunghezza = 98 cm - length = 98 cm

ART.	finitura - finishing		H	H2	DX	SX
ACCIAIO - STAINLESS STEEL						
GPS4/8	acciaio inox satinato AISI 304 DIN 1.4301 satin stainless steel AISI 304 DIN 1.4301		8	23	31705	31707
GPS4/10	acciaio inox satinato AISI 304 DIN 1.4301 satin stainless steel AISI 304 DIN 1.4301		10	23	31715	31717
GPS4/12	acciaio inox satinato AISI 304 DIN 1.4301 satin stainless steel AISI 304 DIN 1.4301		12,5	23	31725	31727

lunghezza = 120 cm - length = 120 cm

ART.	finitura - finishing		H	H2	DX	SX
ACCIAIO - STAINLESS STEEL						
GPS4/8	acciaio inox satinato AISI 304 DIN 1.4301 satin stainless steel AISI 304 DIN 1.4301		8	26	31735	31737
GPS4/10	acciaio inox satinato AISI 304 DIN 1.4301 satin stainless steel AISI 304 DIN 1.4301		10	26	31745	31747
GPS4/12	acciaio inox satinato AISI 304 DIN 1.4301 satin stainless steel AISI 304 DIN 1.4301		12,5	26	31755	31757

lunghezza = 148 cm - length = 148 cm

ART.	finitura - finishing		H	H2	DX	SX
ACCIAIO - STAINLESS STEEL						
GPS4/8	acciaio inox satinato AISI 304 DIN 1.4301 satin stainless steel AISI 304 DIN 1.4301		8	31	31765	31767
GPS4/10	acciaio inox satinato AISI 304 DIN 1.4301 satin stainless steel AISI 304 DIN 1.4301		10	31	31775	31777
GPS4/12	acciaio inox satinato AISI 304 DIN 1.4301 satin stainless steel AISI 304 DIN 1.4301		12,5	31	31785	31787



lunghezza = 200 cm - length = 200 cm

ART.	finitura - finishing		H	H2	DX	SX
ACCIAIO - STAINLESS STEEL						
GPS4/8	acciaio inox satinato AISI 304 DIN 1.4301 satin stainless steel AISI 304 DIN 1.4301		8	49	31790	31791
GPS4/10	acciaio inox satinato AISI 304 DIN 1.4301 satin stainless steel AISI 304 DIN 1.4301		10	49	31794	31795
GPS4/12	acciaio inox satinato AISI 304 DIN 1.4301 satin stainless steel AISI 304 DIN 1.4301		12,5	49	31798	31799

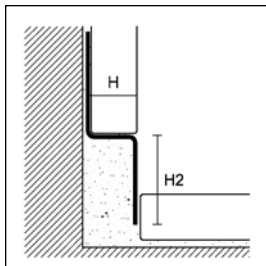
GPS5/



GPS5/

lunghezza = 125 cm - length = 125 cm		H2	
ART.	finitura - finishing	H	23 33
ACCIAIO - STAINLESS STEEL			
GPS5/10/	acciaio inox satinato AISI 304 DIN 1.4301 <i>satin stainless steel</i> AISI 304 DIN 1.4301	 10	31551 31553
GPS5/12/	acciaio inox satinato AISI 304 DIN 1.4301 <i>satin stainless steel</i> AISI 304 DIN 1.4301	 12,5	31555 31557



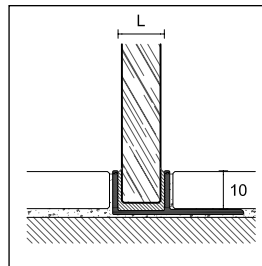

GPS5/

GU/ - TGU/



TGU/

lunghezza = 270 cm - length = 270 cm		L	
ART.	finitura - finishing	12	14
ALLUMINIO - ALUMINIUM			
TGU/	anodizzato argento <i>silver anodised</i>	 67760	67762

lunghezza = 270 cm - length = 270 cm		L	
ART.	finitura - finishing	12	14
ALLUMINIO - ALUMINIUM			
GU/30/	anodizzato argento <i>silver anodised</i>	 67770	67772
GU/40/	anodizzato argento <i>silver anodised</i>	 67780	67782

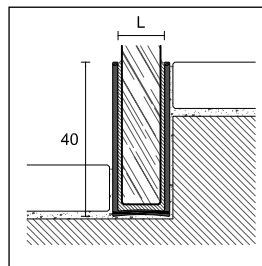

GU/40/

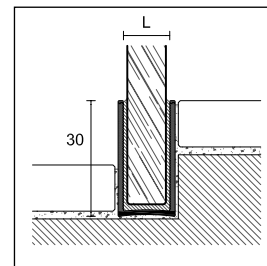

GU/30/



glassprofile



www.profilpas.com

