

DELTA[®]

DELTA[®] protects property. Saves energy. Creates comfort.

DÖRKEN

DELTA[®]-NB

Dimpled sheet.



Secure foundation wall protection and sub-base course. Fast and easy to install.

DELTA[®]-NB

Protection and drainage system for vertical and horizontal waterproofing systems.

With its excellent performance record, this dimpled sheet offers outstanding safety in building construction and civil engineering. It is equally suitable for use as a sub-base course, a foundation liner, a seepage layer in double-wall structures, and below screed, where DELTA[®]-NB offers protection from rising damp.

Handy accessories

- DELTA[®]-NOPPENBAHNEN-PROFIL
- DELTA[®]-HAFTNAGEL
- DELTA[®]-MS DÜBEL
- DELTA[®]-MS KNOFF

Technical Data Overview:	
Material	Special high-density PE, plasticizer-free, fully recyclable.
Colour	Black
Flat edge	Yes
Dimple height	approx. 8 mm
Dimple count	> 1,800
Diagonal dimple structure	For straight-line creasing and precise corner formation.
Air gap between dimples	approx. 5.3 l/m ²
Contact area dimples/substrate	approx. 1,450 cm ² /m ²
Compressive strength	approx. 200 kN/m ² ~ approx. 20 t/m ²
Operating temperature range	Operating temperature range
Chemical properties	Resistant to chemicals and root penetration, rot-proof, non-polluting for drinking water.
Roll size	20 m x 1.0 m, 20 m x 1.5 m, 20 m x 2.0 m, 20 m x 2.4 m, 20 m x 3.0 m
Packing units	15 rolls per pallet for sheets 1.0 m, 1.5 m or 2.0 m wide. 35 rolls per pallet for sheets 2.4 m or 3.0 m wide.

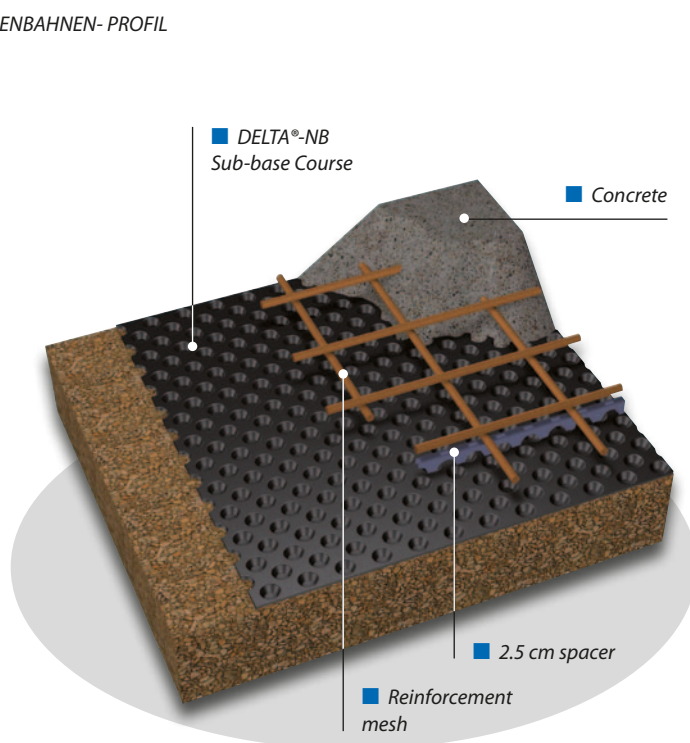
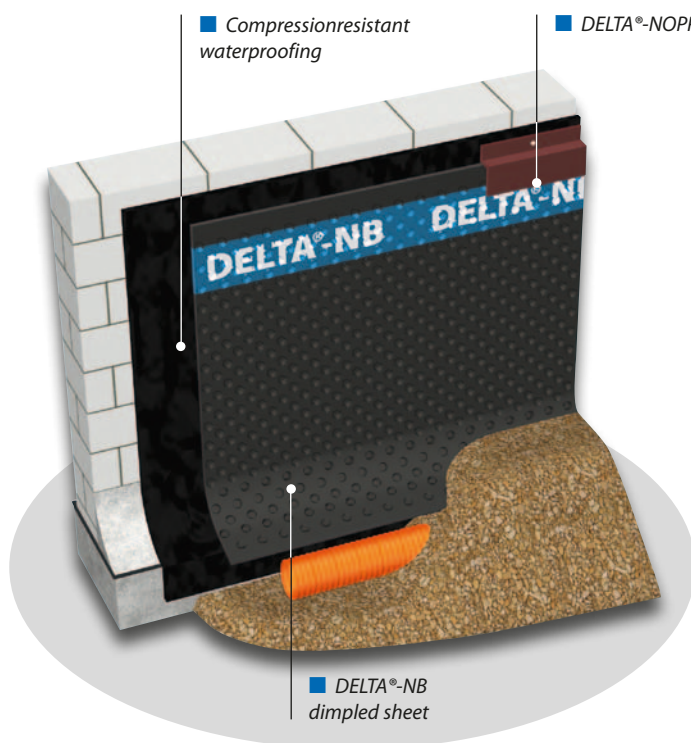

DELTA[®] is a registered trademark of Ewald Dörken AG, Herdecke, Germany.



Dörken GmbH & Co. KG
Wetterstraße 58
D-58313 Herdecke
Tel.: +49 23 30/63-0
Fax: +49 23 30/63-355
bvfd@doerken.de
www.doerken.com

A company
of the Dörken Group



Standard requests for tender as well as detailed installation instructions for all DELTA[®]-Products may be obtained at www.doerken.com as pdf files for you to print out and save.